

LUFKIN THREE DEPARTURE

D-ATIS
124.6
CLNC DEL
125.45
CPDLC
GND CON
121.9
HOBBY TOWER
118.7 256.9
HOUSTON DEP CON
132.25 285.425

**TOP ALTITUDE:
16000**

LITTLE ROCK
113.9 LIT : : :
Chan 86
N34°40.66'
W92°10.83'
L-18, H-6

NOTE: RADAR and DME required.
NOTE: For aircraft destined LIT or
overflying LIT or PXV.

LUFKIN
112.1 LFK : : :
Chan 58
N31°09.75'
W94°43.01'

SKKIP
N31°14.91'
W94°39.45'
5000
023°
(6)

SUSHI
N30°35.48'
W95°04.39'
023°
(39)

COLET
N30°26.96'
W95°09.66'
023°
(10) (48)

KYANN
N30°15.53'
W95°13.96'
013°
(12) (31)

HUMBLE
116.6 IAH : : :
Chan 113

DAISETTA
116.9 DAS : : :
Chan 116

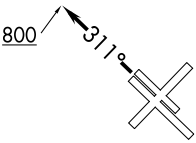

TAKEOFF MINIMUMS
Rwys 4, 13L/R, 31L/R: Standard.
Rwy 22: Standard with minimum climb of 290' per
NM to 1500.

SC-5, 07 OCT 2021 to 04 NOV 2021

SC-5, 07 OCT 2021 to 04 NOV 2021

NOTE: Chart not to scale.

(NARRATIVE ON FOLLOWING PAGE)