

AIRPORT DIAGRAM

AL-895 (FAA)

SMYRNA (MQY)
SMYRNA, TENNESSEE

AWOS-3PT
119.125
SMYRNA TOWER ✱
118.5 233.1
GND CON
121.4
CLNC DEL
121.4
121.7 (when tower closed)

↑
121.7
↑
121.7 (when tower closed)
↑
MAG. VAR. 30° W
JANUARY 2020
ANNUAL RATE OF CHANGE
0.1° W

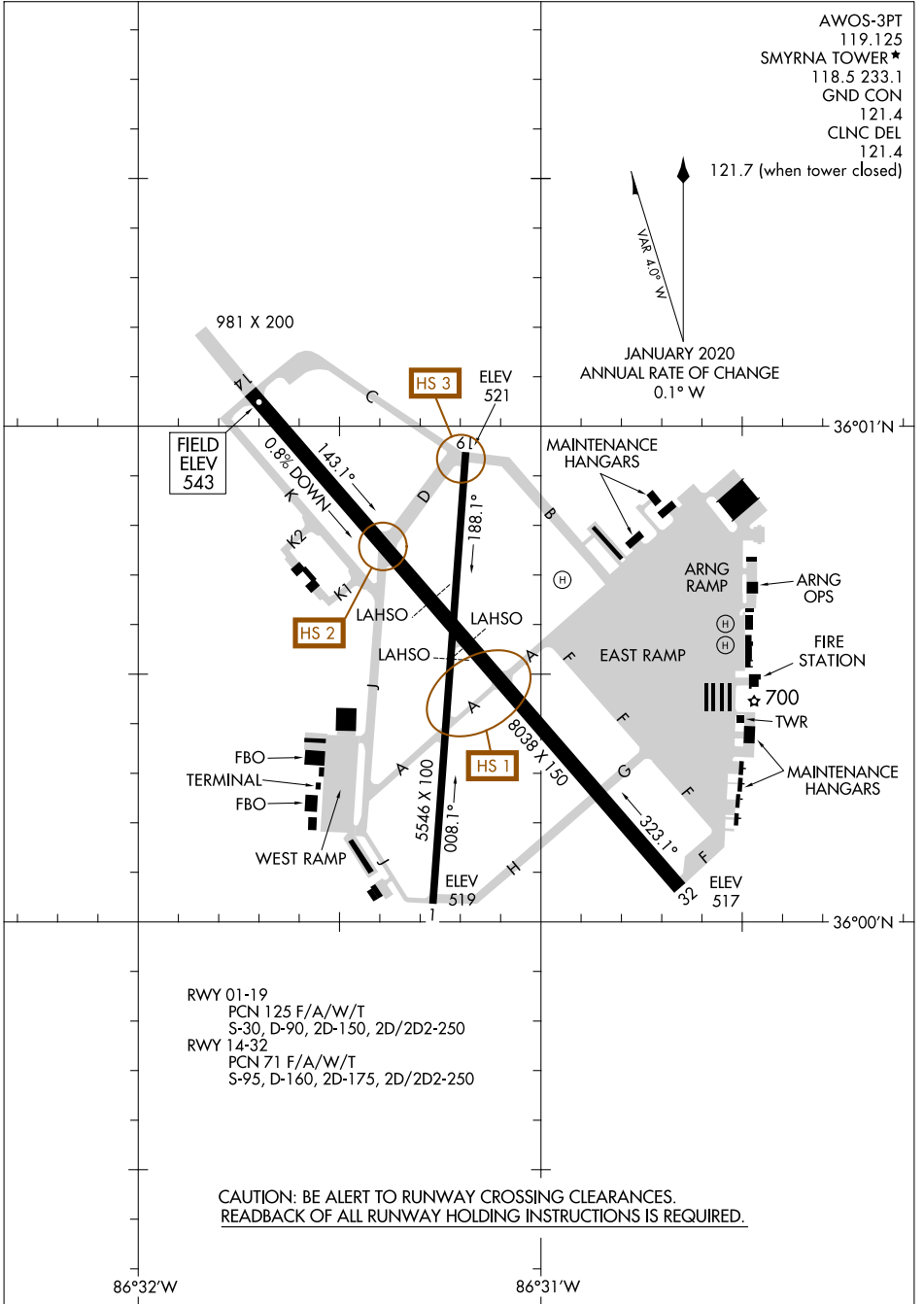

RWY 01-19
PCN 125 F/A/W/T
S-30, D-90, 2D-150, 2D/2D2-250
RWY 14-32
PCN 71 F/A/W/T
S-95, D-160, 2D-175, 2D/2D2-250

**CAUTION: BE ALERT TO RUNWAY CROSSING CLEARANCES.
READEBACK OF ALL RUNWAY HOLDING INSTRUCTIONS IS REQUIRED.**

86°32'W

86°31'W

AIRPORT DIAGRAM

SMYRNA, TENNESSEE
SMYRNA (MQY)

SE-1, 18 MAY 2023 to 15 JUN 2023

SE-1, 18 MAY 2023 to 15 JUN 2023