

**PERHAM MUNI** (16D) 2 NW UTC-6(-5DT) N46°36.66' W95°36.37'

1376 B NOTAM FILE PNM

**RWY 13-31:** H4102X75 (ASPH) MIRL

**RWY 13:** REIL. PAPI(P4L)—GA 3.0° TCH 45'.

**RWY 31:** REIL. PAPI(P4L)—GA 3.0° TCH 45'.

**SERVICE:** FUEL 100LL LGT MIRL Rwy 13-31 preset to low ints, to incr ints and ACTIVATE PAPI Rwy 13 and Rwy 31; REIL Rwy 13 and Rwy 31—CTAF.

**AIRPORT REMARKS:** Unattended. Fuel avbl 24 hrs with credit card. Ultralights on and invof arpt. Helicopter ops, northwest corner of arpt.

**AIRPORT MANAGER:** (218) 346-4455

**COMMUNICATIONS:** CTAF 122.9

MINNEAPOLIS CENTER APP/DEP CON 126.1

GCO 121.725

**CLEARANCE DELIVERY PHONE:** For CD if una via GCO ctc Minneapolis ARTCC at 651-463-5588.

**RADIO AIDS TO NAVIGATION:** NOTAM FILE DTL.

DETROIT LAKES (T) (T) VOR/DME 111.2 DTL Chan 49 N46°49.53'

W95°53.24' 136° 17.3 NM to fld. 1385/2E. VOR/DME unmonitored.

TWIN CITIES

L-14H

IAP

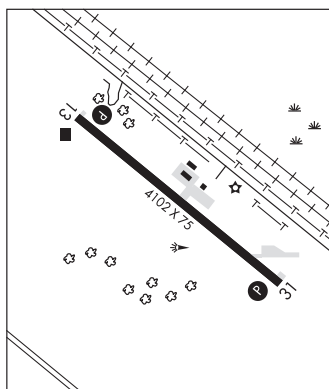

**PINE RIVER RGNL** (PWC)(KPWC) 1 E UTC-6(-5DT) N46°43.49' W94°22.90'

1296 NOTAM FILE PWC

**RWY 16-34:** H3000X75 (ASPH) MIRL

**RWY 16:** REIL. VASI(V2L)—GA 3.0° TCH 22'.

**RWY 34:** REIL. VASI(V2L)—GA 3.0° TCH 22'.

**SERVICE:** FUEL 100LL LGT Actvt or incr instst REIL Rwy 16 and 34; VASI Rwy 16 and 34; MIRL Rwy 16-34—CTAF. MIRL Rwy 16-34 preset med instst.

**AIRPORT REMARKS:** Unattended. Deer and waterfowl on and invof arpt.

Ultralights on and invof arpt. For emerg call 218-821-3521. Fuel avbl H24 self ser via credit card. Aft hrs call 218-821-3521. Cfm snow removal and winter conds call 218-821-3521. Rwy 34 calm wind rwy.

**AIRPORT MANAGER:** 218-587-2440

**WEATHER DATA SOURCES:** AWOS-3 118.525 (218) 587-3420.

**COMMUNICATIONS:** CTAF 122.9

MINNEAPOLIS CENTER APP/DEP CON 118.05

**CLEARANCE DELIVERY PHONE:** For CD ctc Minneapolis ARTCC at 651-463-5588.

**RADIO AIDS TO NAVIGATION:** NOTAM FILE PKD.

PARK RAPIDS (L) DME 110.6 PKD Chan 43 N46°53.89'

W95°04.26' 110° 30.3 NM to fld. 1472.

TWIN CITIES

L-14H

IAP

