

MINDEN-TAHOE (MEV)(KMEV) 4 N UTC-8(-7DT) N39°00.03' W119°45.07'

SAN FRANCISCO

4724 B NOTAM FILE MEV

H-3B, L-9A

RWY 16-34: H7399X100 (ASPH) S-50, D-75 PCR 40 F/C/X/T HIRL

IAP, AD

RWY 16: REIL. VASI(V4R)—GA 3.0° TCH 40'. Rgt tfc.

RWY 34: REIL. VASI(V4L)—GA 3.0° TCH 31'.

RWY 12-30: H5299X75 (ASPH) S-50, D-75 PCR 10 F/C/X/T

0.4% up SE

RWY 12: Tree. Rgt tfc.

RWY 12G-30G: 2050X60 (DIRT) 0.6% up SE

SERVICE: S4 FUEL 100LL, JET A **OX3** LGT ACTVT REIL Rwy 16 and 34; VASI Rwy 16 and 34; HIRL Rwy 16-34—CTAF.

NOISE: Noise abatement proc in efct—775-782-9871.

AIRPORT REMARKS: Attended 1600-0100Z†. Glider, ultralight, skydiving, sailplane and balloon act on and invof arpt. Mowers invof arpt and rws. Snow removal durg dalgt only. Emerg aft 0100Z†—775-782-5126. Rwy 30G thr mkd with orange and white panels. Trees 1,440' from apch end Rwy 12. Ditch in obstacle free zone adjacent SW end Twy C. Men and equipment occasionally on rws and twys. Skydiving act on and invof arpt. Rwy 30G Indg only; Rwy 12G tkof and Indg NA. Sailplane pattern right tfc Rwy 30 and Rwy 34. NOTE: See Special Notices—Glider/Soaring Activities Around the Reno-Tahoe International Airport.

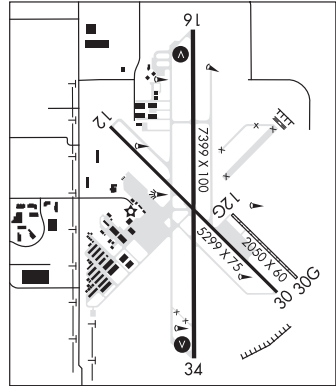

AIRPORT MANAGER: 775-782-9871

WEATHER DATA SOURCES: AWOS-3PT 119.325 (775) 782-6264.

COMMUNICATIONS: CTAF/UNICOM 123.05

Ⓡ **NORCAL APP/DEP CON** 119.2

CLNC DEL 133.25

CLEARANCE DELIVERY PHONE: For CD ctc NorCal Apch at 916-361-6874.

RADIO AIDS TO NAVIGATION: NOTAM FILE RNO.

MUSTANG (VH) (H) VORTACW 117.9 FMG Chan 126 N39°31.88' W119°39.36' 172° 32.1 NM to fld. 5950/16E.

VOR unusable:

002°-012° byd 40 NM blo 19,000'

013°-022° byd 40 NM blo 10,300'

013°-022° byd 53 NM

023°-045° byd 40 NM

079°-113° byd 40 NM

114°-124° byd 40 NM blo 10,000'

114°-124° byd 52 NM

125°-145° byd 40 NM

153°-172° byd 40 NM blo 15,000'

153°-172° byd 52 NM blo 18,000'

173°-186° byd 40 NM

187°-197° byd 40 NM blo 15,000'

187°-197° byd 66 NM

198°-212° byd 40 NM

200°-230° byd 30 NM blo 13,000'

213°-223° byd 40 NM blo 18,000'

224°-304° byd 40 NM

327°-339° byd 40 NM blo 18,000'

356°-001° byd 40 NM

TACAN AZIMUTH unusable:

200°-230° byd 30 NM blo 13,000'

DME unusable:

200°-230° byd 30 NM blo 13,000'

MORMON MESA N36°46.16' W114°16.65' NOTAM FILE RNO.

LAS VEGAS

(L) (L) **VORTAC** 113.1 MMM Chan 78 198° 14.5 NM to Perkins Fld. 2106/16E.

H-4I, L-9B

VOR unusable:

060°-110° byd 25 NM blo 15,000'

110°-135° byd 15 NM

270°-335° byd 10 NM

TACAN AZIMUTH unusable:

060°-110° byd 25 NM blo 15,000'

110°-135° byd 15 NM

270°-340° byd 10 NM

DME unusable:

060°-110° byd 25 NM blo 15,000'

110°-135° byd 15 NM

270°-340° byd 10 NM

RCO 122.1R 113.1T (RENO RADIO)