

(OOM5.OOM) 23334

# HOOSIER FIVE DEPARTURE

AL-5514 (FAA)

SHELBYVILLE MUNI (GÆZ)

SHELBYVILLE, INDIANA

ASOS  
121.55  
INDIANAPOLIS DEP CON  
127.15 317.8

**TOP ALTITUDE:  
ASSIGNED BY ATC**

BRICKYARD  
116.3 VHP   
Chan 110

HOOSIER  
110.2 OOM   
Chan 39

POCKET CITY  
113.3 PXV   
Chan 80

**TAKEOFF MINIMUMS:**  
Rwys 1, 19: Standard.  
Rwys 9, 27: NA - Environmental.

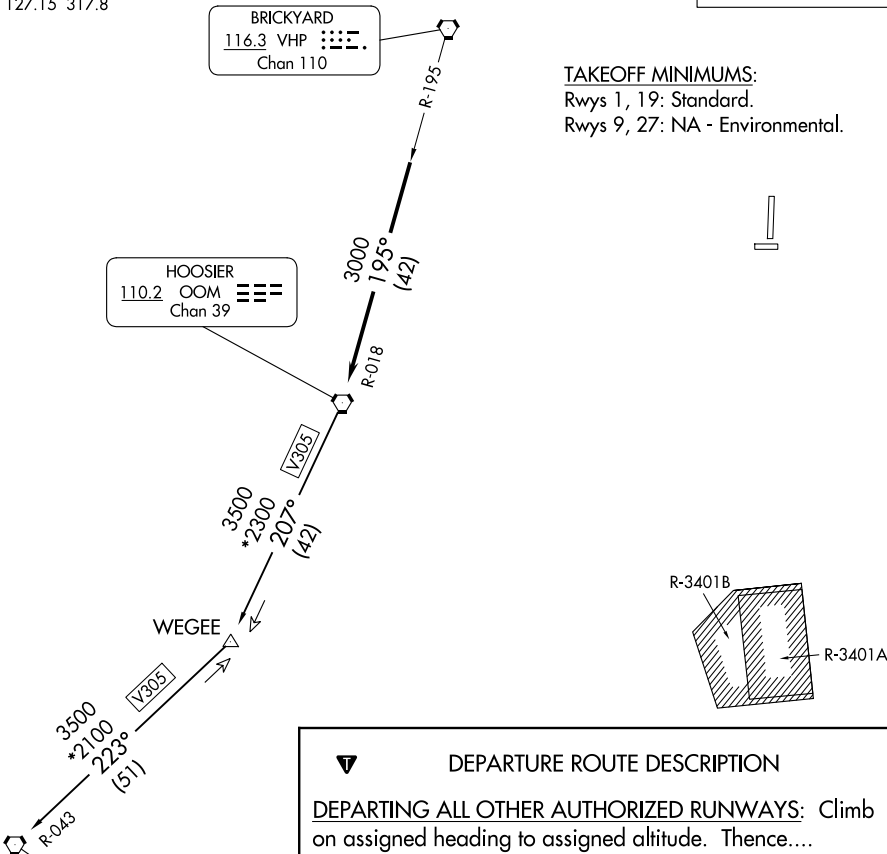

**DEPARTURE ROUTE DESCRIPTION**

**DEPARTING ALL OTHER AUTHORIZED RUNWAYS:** Climb on assigned heading to assigned altitude. Thence....

....expect RADAR vectors to join VHP R-195 to OOM VORTAC then via transition or assigned route. Expect clearance to requested altitude ten minutes after departure.

**POCKET CITY TRANSITION (OOM5.PXV):** From over OOM VORTAC via OOM R-207 to WEGEE, then via PXV R-043 to PXV VORTAC.

- NOTE: RADAR required.
- NOTE: Select appropriate localizer/DME frequency/channel prior to departure.
- NOTE: Turbojets accelerate to 250K until reaching 10000, if unable advise ATC.
- NOTE: Assigned to aircraft with a requested altitude of 11000 or above.

NOTE: Chart not to scale.

EC-2, 26 DEC 2024 to 23 JAN 2025

EC-2, 26 DEC 2024 to 23 JAN 2025

# HOOSIER FIVE DEPARTURE

(OOM5.OOM) 01FEB18

SHELBYVILLE, INDIANA

SHELBYVILLE MUNI (GÆZ)